

Power Steering

Steering Column Removal and Installation

SRS components are located in this area. Review the SRS component locations (see page 23-11) and the precautions and procedures (see page 23-13) before doing repairs or service.

Removal

1. Make sure you have the anti-theft codes for the audio system and the navigation system (if equipped), then write down the audio presets.
2. Make sure the ignition switch is OFF, then disconnect the negative cable from the battery.
3. Remove the steering wheel (see page 17-23).
4. Remove the driver's dashboard undercover (see page 20-82).
5. Remove the driver's dashboard lower cover (see page 20-82).
6. Remove the column covers.
7. Remove the steering joint cover A.

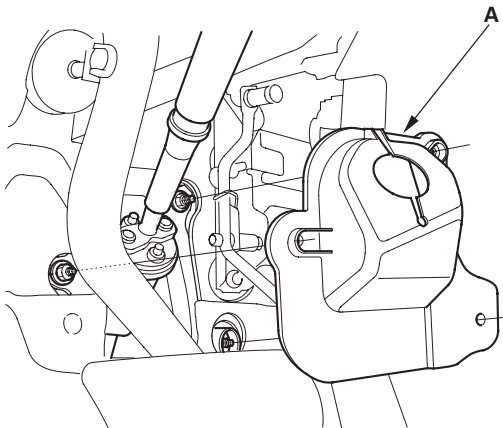

8. Release the lock lever, and adjust the steering column to the full tilt up position, and to the full telescopic in position.
9. Tighten the lock lever.

10. Hold the lower slide shaft (A) on the column with a piece of wire (B) between the joint yoke (C) of the lower slide shaft and joint yoke (D) of the upper shaft to prevent the slider shaft from pulling out.

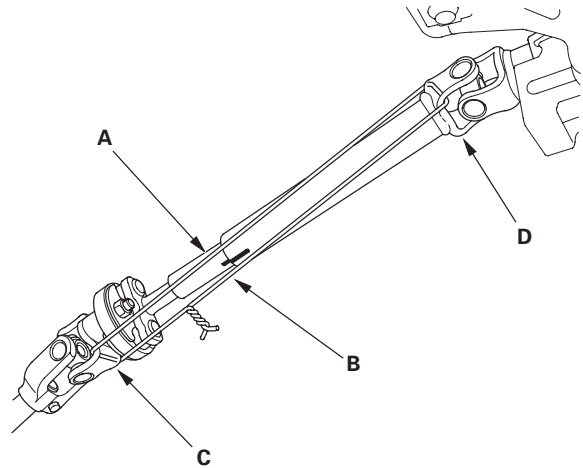

11. Release the lock lever, and adjust the steering column to the full telescopic out position, then tighten the lock lever.