

# Engine Assembly

## Engine Installation (cont'd)

2. Attach the chain hoist to the engine/transmission, then install the engine/transmission into position in the vehicle.

NOTE: Reinstall the mounting bolts/support nuts in the sequence given in the following steps. Failure to follow this sequence may cause excessive noise, vibration, and reduce bushing life.

3. Tighten the front mount bolt (A), then install the front mount stop (B), vacuum hose clamp bracket (C), and vacuum hose (D).

12 x 1.25 mm  
79 N·m (8.0 kgf·m, 58 lbf·ft)

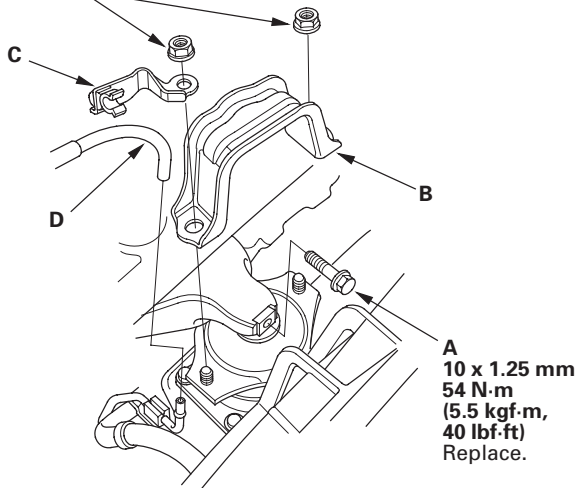

4. Tighten the rear mount bolt (A), then install the rear mount stop (B).

12 x 1.25 mm  
69 N·m (7.0 kgf·m, 51 lbf·ft)

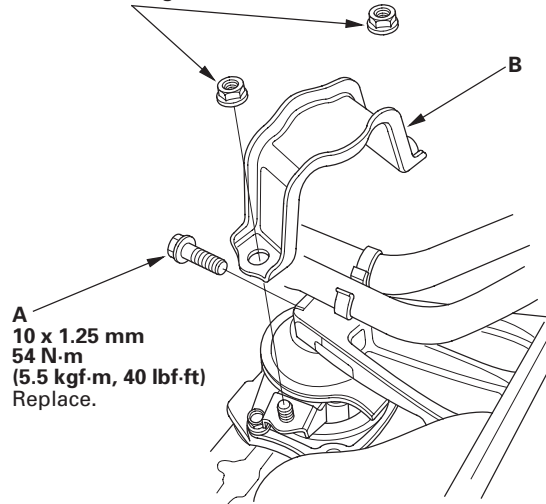

5. Install the upper bracket (A), then tighten the bolts in the sequence shown.

① 12 x 1.25 mm  
54 N·m (5.5 kgf·m, 40 lbf·ft)

6 x 1.0 mm  
12 N·m  
(1.2 kgf·m, 8.8 lbf·ft)

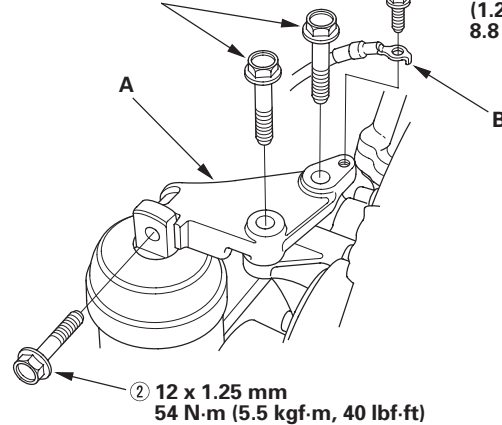

6. Install the ground cable (B).