

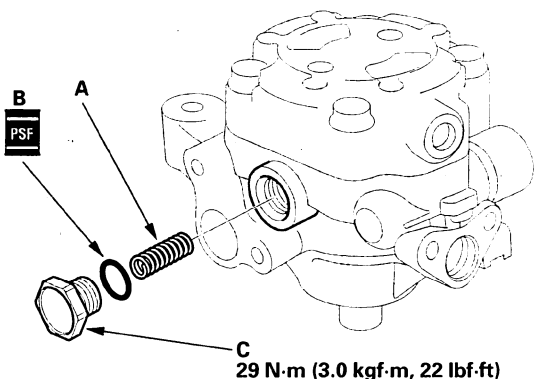

37. Install the pump preload spring (A) in the pump housing.

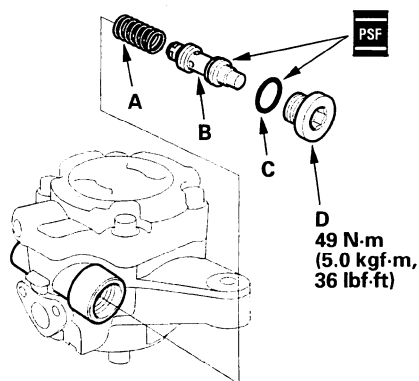

38. Coat the new 12.7 mm O-ring (B) with power steering fluid, and install it on the pump housing cap (C).
39. Install the pump housing cap on the pump housing, and tighten it to specified torque.
40. Install the pressure control valve spring (A) in the pump housing.



41. Coat the pressure control valve (B) with power steering fluid, and install it on the pump housing.
42. Coat the new 16.7 mm O-ring (C) with power steering fluid, and install it on the pressure control valve cap (D).
43. Install the pressure control valve cap on the pump housing, and tighten it to the specified torque.

44. Coat the new 13 mm O-ring (A) with power steering fluid, and install it on the inlet joint (B).

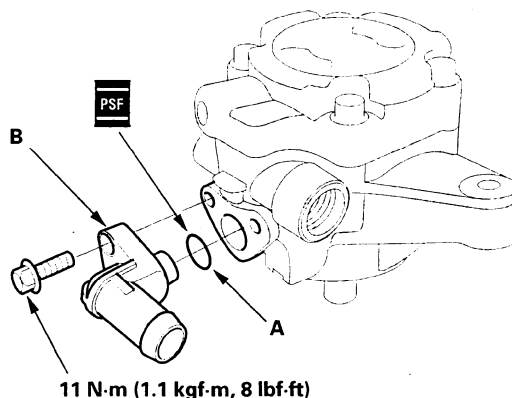

45. Install the inlet joint on the pump housing.
46. Install the pulley (A), then loosely install the pulley nut (B). Hold the power steering pump in a vise with soft jaws (C). Be careful not to damage the pump housing with the jaws of the vise.

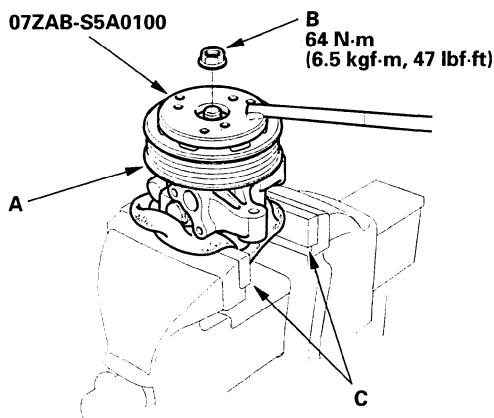

47. Hold the pulley with the special tool, and tighten the pulley nut to specified torque.
48. Check that the pump turns smoothly by turning the pulley. If it turns hard, loosen the four flange bolts on the cover, then retightening them in the same manner as in the step 35. Turning the pump again by hand.