

June 11, 2014

ATB 51252 REV-1 (1406)

## Driver's Power Seat And Seat Memory Settings Do Not Work Properly

Supersedes 14-025, dated May 16, 2014, to revise the information highlighted in **yellow**.

### AFFECTED VEHICLES

Year	Model	Trim	VIN Range
2013	Accord 2-Door	EX-L V6	ALL
2013	Accord 4-Door	EX-L L4	ALL
2013	Accord 4-Door	EX-L V6, Touring	ALL
2014	Accord 2-Door	EX-L V6	1HGCT2...EA000001 to 1HGCT2...EA006070
2014	Accord 4-Door	EX-L L4	1HGCR2...EA000001 to 1HGCR2...EA179134
2014	Accord 4-Door	EX-L V6, Touring	1HGCR3...EA000001 to 1HGCR3...EA028057
2014	Accord Hybrid	EX-L, Touring	1HGCR6...EA000001 to 1HGCR6...EA005280
2014	Accord Plug-In	ALL	ALL

### SYMPTOM

The driver's power seat moves only in small increments when the switch is used. In addition, memory settings may not work on vehicles equipped with the driving position memory system.

### POSSIBLE CAUSES

The driver's power seat adjustment switch is faulty.

### CORRECTIVE ACTION

Replace the driver's power seat adjustment switch.

### PARTS INFORMATION

Part Name	Part Number	Quantity
Power Seat Adjustment Switch (MSC SW UNIT ASSY)	81650-T2F-A52ZA	1

### WARRANTY CLAIM INFORMATION

The normal warranty applies.

Operation Number	Description	Flat Rate Time	Template ID	Failed Part Number
7491B3	Replace the driver's power seat adjustment switch.	0.5 hour	14-025A	81650-T2F-A51ZA

Defect Code: 03217

Symptom Code: 04201

Skill Level: Repair Technician

### REPAIR PROCEDURE

NOTE: SRS components are in this area. Review the SRS component locations, precautions, and procedures before doing repairs or service.

**CUSTOMER INFORMATION:** The information in this bulletin is intended for use only by skilled technicians who have the proper tools, equipment, and training to correctly and safely maintain your vehicle. These procedures should not be attempted by "do-it-yourselfers," and you should not assume this bulletin applies to your vehicle, or that your vehicle has the condition described. To determine whether this information applies, contact an authorized Honda automobile dealer.

1. Remove the driver's seat belt lower anchor bolt.

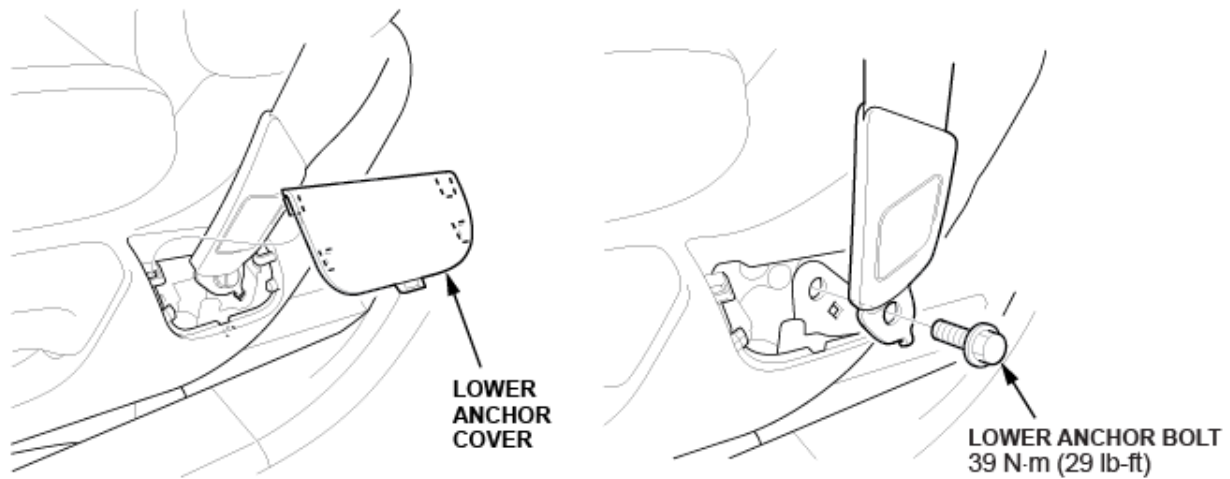

2. Remove the driver's seat rear foot covers and rear mounting bolts.

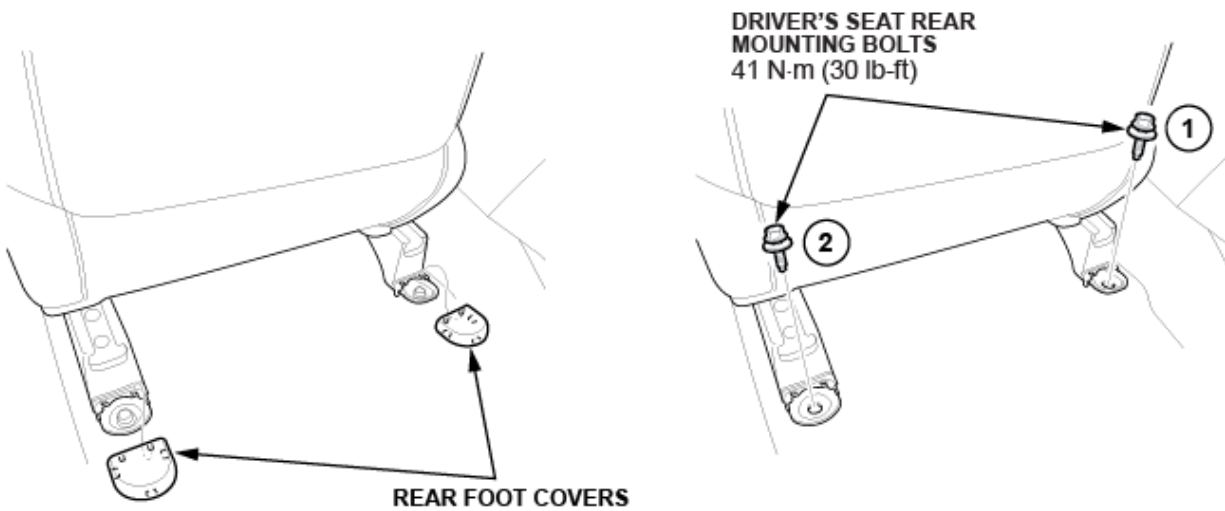

3. Move the driver's seat all the way back.
4. Remove the driver's seat front mounting bolts.

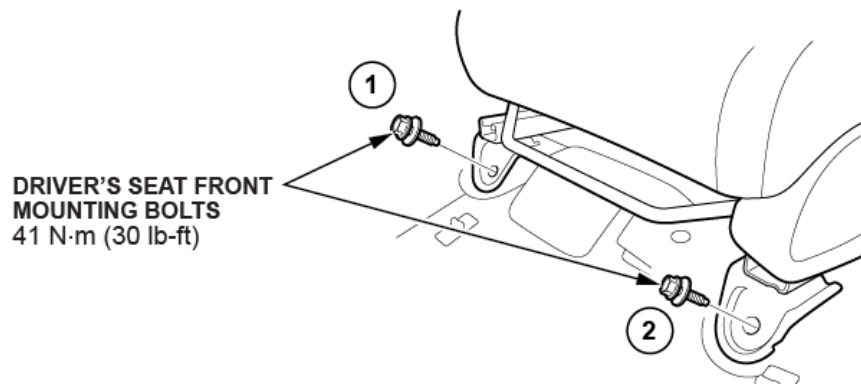

5. Disconnect and isolate the negative battery cable, then wait **3 minutes**.

6. Lift up the front seat, disconnect the connectors, and release the harness clip.

**2-DOOR**

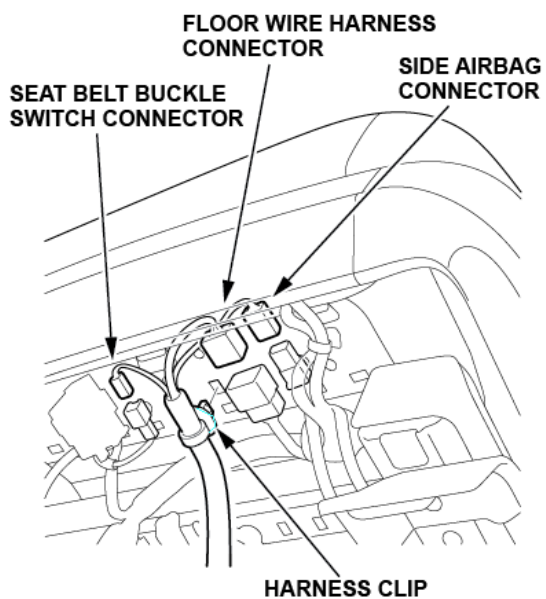

**4-DOOR**

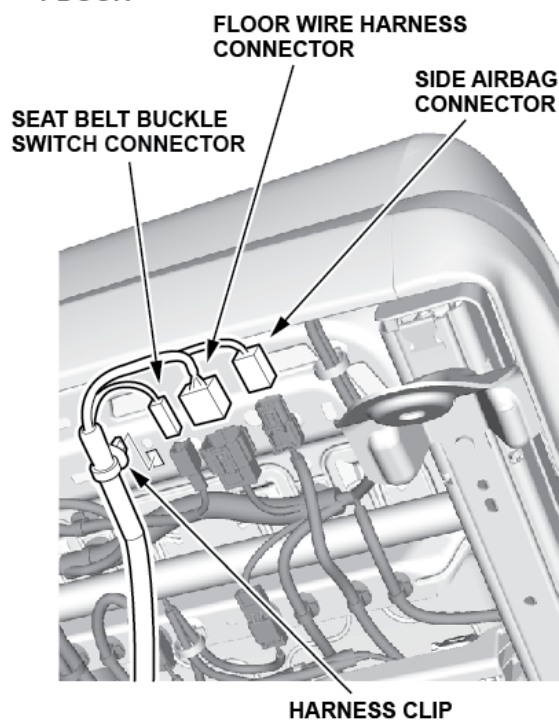

7. Remove the driver's seat.

8. Remove the driver's seat front cover panel.

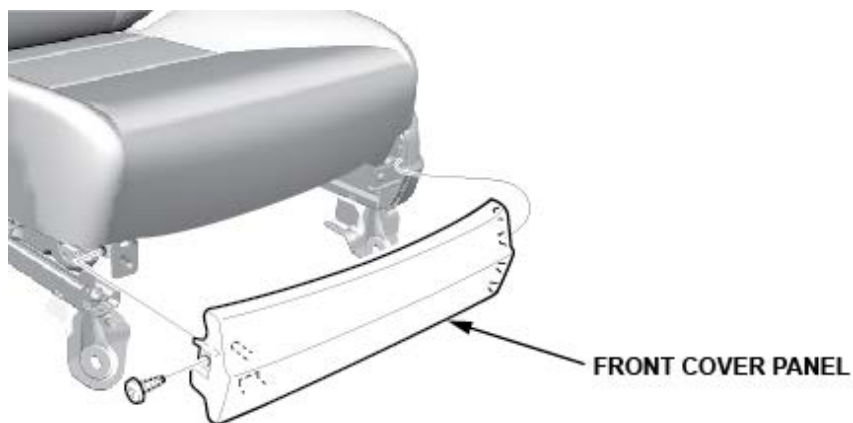

9. Remove the driver's seat recline cover.

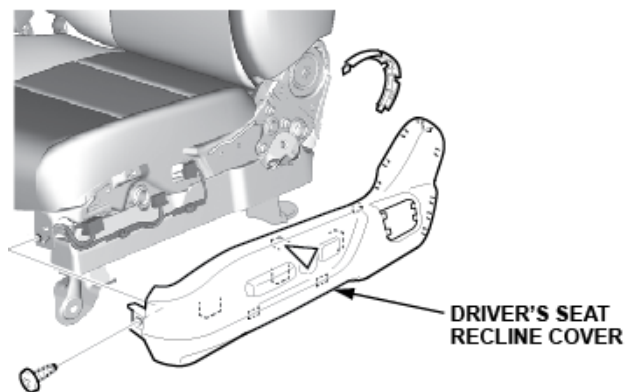

10. Remove the driver's power seat adjustment switch knobs, then remove the driver's power seat adjustment switch.

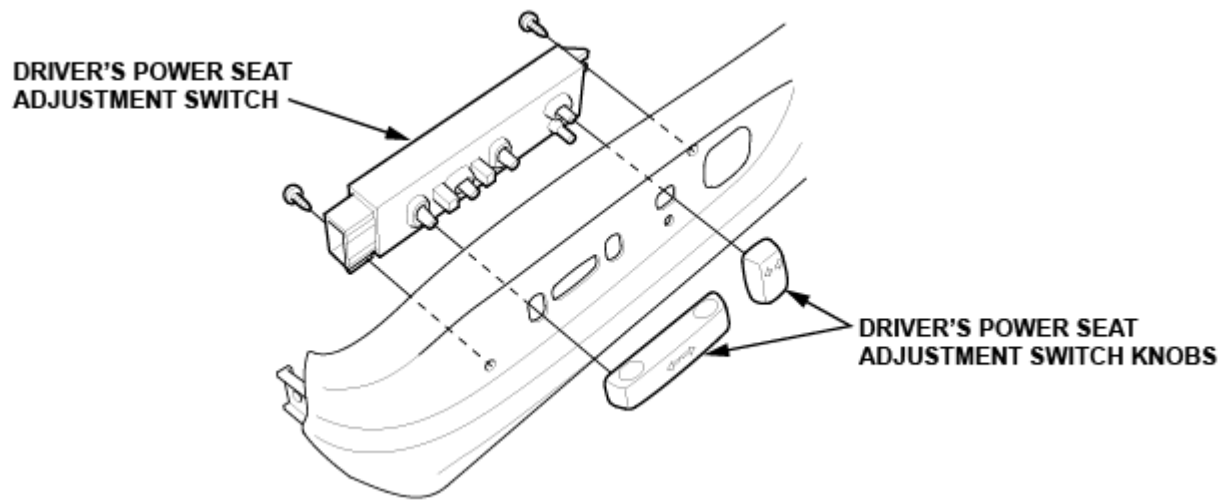

11. Install the new driver's power seat switch.

12. Reinstall all parts in the reverse order of removal, and reconnect the battery negative cable.